

Model	Year	MG	SG	Illustration	Restrictions	UPD	10:47	20.09.2014	ETKA	
A2	2005	8	63	863-00		0				

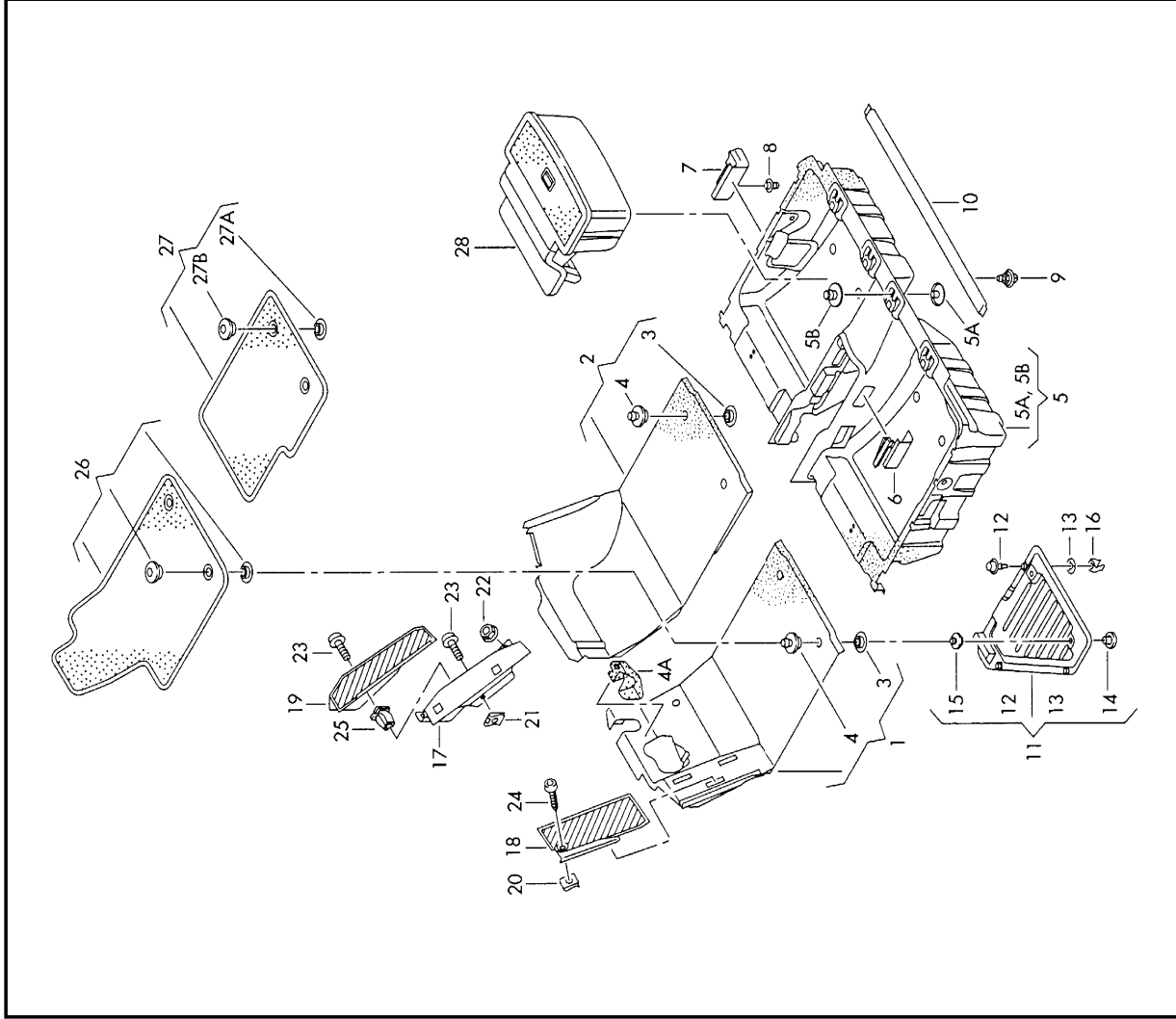

Pos	Part Number	Description	Remark	Qty	Model
1	821 863 101 A	floor covering foot support cover shelf with cover	left a. right	1	PR-T1Q
	07/01-08/053K2	platinum	left -YG, NH		
	07/01-08/0590G	soul (black)	-YA, YH, YJ, YK, YL, QE, NE, NN, NP, NT, NU		
	06/00-06/0191H	swing (dark grey)	-YB		
	06/00-08/0592J	twist (beige)	-YC, NV		
(1)	821 863 101 B	floor cover	left -YG, NH	1	PR-T4A
	07/01-08/053K2	platinum	-YA, YH, YJ, YL, NE, NN, NP, NT, NU		
	07/01-08/0590G	soul (black)	-YC, NV		
	03/01-08/0592J	twist (beige)	left -YG, NH	1	PR-T0U, T94, T60
(1)	821 863 101 C	floor cover	left -YG, NH		
	07/01-08/053K2	platinum	-YA, YH, YJ, YK, YL, QE, NE, NN, NP, NT, NU		
	07/01-08/0590G	soul (black)	-YB		
	06/00-06/0191H	swing (dark grey)	-YC, NV		
	06/00-08/0592J	twist (beige)	left -YG, NH	1	
(1)	822 863 101 B	floor cover	right -YG, NH		
	07/01-08/053K2	platinum	-YA, YH, YJ, YK, YL, QE, NE, NN, NP, NT, NU		
	07/01-08/0590G	soul (black)	-YB		
	08/00-06/0191H	swing (dark grey)	-YC, NV		
	08/00-08/0592J	twist (beige)	right -YG, NV	1	PR-T1Q
2	821 863 102 B	floor cover			

Model	Year	MG	SG	Illustration	Restrictions	UPD	10:47	20.09.2014	ETKA	
A2	2005	8	63	863-00		0				

Pos	Part Number	Description	Remark	Qty	Model	Pos	Part Number	Description	Remark	Qty	Model
	07/01-08/053K2	platinum	-YG,NH				06/00-08/051RS	twist (beige)	-YC,NV		
	07/01-08/0590G	soul (black)	-YA,YH,YJ,YK, YL,QE,NE,NN, NP,NT,NU				06/00-06/0124S	swing (dark grey)	-YB		
	06/00-06/0191H	swing (dark grey)	-YB				07/01-08/054PK	soul (black)	-YA,YH,YJ,YK, YL,QE,NE,NN, NP,NT,NU		
	06/00-08/0592J	twist (beige)	-YC,NV			4A		cover for steering column see illustration:	419-35		
2	821 863 102 B	floor cover	right lhd	1	PR-T4A	5	820 863 717 A	floor cover for 2 seater bench seat rework if necessary	rear	1	PR-3NC
	07/01-08/053K2	platinum	-YG,NH								
	07/01-08/0590G	soul (black)	-YA,YH,YJ,YL, NE,NN,NP,NT, NU				07/01-08/053K2	platinum	-YG,NH		
	03/01-08/0592J	twist (beige)	-YC,NV				07/01-08/0590G	soul (black)	-YA,YH,YJ,YK, YL,QE,NE,NN, NP,NT,NU		
(2)	821 863 102 C	floor cover	right lhd	1	PR-T0U, T94, T60		06/00-06/0191H	swing (dark grey)	-YB		
	07/01-08/053K2	platinum	-YG,NH				06/00-08/0592J	twist (beige)	-YC,NV		
	07/01-08/0590G	soul (black)	-YA,YH,YJ,YK, YL,QE,NE,NN, NP,NT,NU			(5)	820 863 717 C	floor cover for 3 seater bench seat rework if necessary	rear	1	PR-3NK
	06/00-06/0191H	swing (dark grey)	-YB								
	06/00-08/0592J	twist (beige)	-YC,NV				07/01-08/053K2	platinum	-YG,NH		
(2)	822 863 102 C	floor cover	right rhd	1			07/01-08/0590G	soul (black)	-YA,YH,YJ,YK, YL,QE,NE,NN, NP,NT,NU		
	07/01-08/053K2	platinum	-YG,NH				09/00-06/0191H	swing (dark grey)	-YB		
	07/01-08/0590G	soul (black)	-YA,YH,YJ,YK, YL,QE,NE,NN, NP,NT,NU				09/00-08/0592J	twist (beige)	-YC,NV		
	08/00-06/0191H	swing (dark grey)	-YB			(5)	820 863 717 E	floor cover	rear	1	1,2 TDI+ PR-3ND
	08/00-08/0592J	twist (beige)	-YC,NV								
3	3D0 864 523	retainer		4			07/01-08/053K2	platinum	-YG,NH		
	06/00-08/05B41	satin black					07/01-08/0590G	soul (black)	-YA,YH,YJ,YL, NE,NN,NP,NT, NU		
4	820 864 229 A	cover cap		4			03/01-08/0592J	twist (beige)	-YC,NV		
	07/01-08/05E59	platinum	-YG,NH			(5)	820 863 717 F	floor cover for models with split rear seat and backrest	rear	1	1,2 TDI+ PR-3NM:6CA

Model	Year	MG	SG	Illustration	Restrictions	UPD	10:47	20.09.2014	ETKA	
A2	2005	8	63	863-00		0				

Pos	Part Number	Description	Remark	Qty	Model	Pos	Part Number	Description	Remark	Qty	Model
	07/01-08/053K2	platinum	-YG,NH				07/01-08/054PK	soul (black)	-YA,YH,YJ,YK, YL,QE,NE,NN, NP,NT,NU		
	07/01-08/0590G	soul (black)	-YA,YH,YJ,YL, NE,NN,NP,NT, NU			(6)	820 864 438	covering guide rail for seat	right inner	1	
	03/01-08/0592J	twist (beige)	-YC,NV				07/01-08/05E59	platinum	-YG,NH		
5	820 863 717 A	floor cover for models with split rear seat and backrest	rear	1	1,2 TDI+ PR-3NM:6CB		06/00-08/051RS	twist (beige)	-YC,NV		
	07/01-08/053K2	platinum	-YG,NH,				06/00-06/0124S	swing (dark grey)	-YB		
	07/01-08/0590G	soul (black)	-YA,YH,YJ,YL, NE,NN,NP,NT, NU				07/01-08/054PK	soul (black)	-YA,YH,YJ,YK, YL,QE,NE,NN, NP,NT,NU		
	03/01-08/0592J	twist (beige)	-YC,NV			(7)	820 864 437 A	covering guide rail for seat	left outer	1	
5A	3D0 864 227	retainer F >> 8Z-2-010 000*	lower	4			07/01-08/05E59	platinum	-YG,NH		
	06/00-08/01B41	satin black					06/00-08/051RS	twist (beige)	-YC,NV		
(5A)	8E0 864 227	retainer F 8Z-2-010 001>>*	lower	4			06/00-06/0124S	swing (dark grey)	-YB		
5B	8E0 864 229	cover cap	upper *>8Z-2-010000 8E0 864 227	4			07/01-08/054PK	soul (black)	-YA,YH,YJ,YK, YL,QE,NE,NN, NP,NT,NU		
	07/01-08/05E59	platinum	-YG,NH			7	820 864 438 A	covering guide rail for seat	right outer	1	
	06/00-08/051RS	twist (beige)	-YC,NV				07/01-08/05E59	platinum	-YG,NH		
	06/00-08/0524S	swing (dark grey)	-YB				06/00-08/051RS	twist (beige)	-YC,NV		
	07/01-08/054PK	soul (black)	-YA,YH,YJ,YK, YL,QE,NE,NN, NP,NT,NU				06/00-06/0124S	swing (dark grey)	-YB		
6	820 864 437	covering guide rail for seat	left inner	1		8	4B0 863 907 A	clip	-YA,YH,YJ,YK, YL,QE,NE,NN, NP,NT,NU	4	
	07/01-08/05E59	platinum	-YG,NH				06/00-08/0501C	satin black			
	06/00-08/051RS	twist (beige)	-YC,NV			9	820 864 993	pin		4	
	06/00-06/0124S	swing (dark grey)	-YB			10	820 864 611	cover strip		1	
							07/01-08/05E59	platinum	-YG,NH		

Model	Year	MG	SG	Illustration	Restrictions	UPD	10:47	20.09.2014	ETKA	
A2	2005	8	63	863-00		0				



Pos	Part Number	Description	Remark	Qty	Model	Pos	Part Number	Description	Remark	Qty	Model
	06/00-08/051RS	twist (beige)	-YC,NV				07/01-08/054PK	soul (black)	-YA,YH,YJ,YK, YL,QE,NE,NN, NP,NT,NU		
	06/00-06/0124S	swing (dark grey)	-YB			20	+ N 015 445 6	snap nut	4, 8X16, 5X11, 5	1	
	07/01-08/054PK	soul (black)	-YA,YH,YJ,YK, YL,QE,NE,NN, NP,NT,NU			21	+ N 104 337 01	snap nut	4, 8X18, 6X16	1	
11	820 863 359	cover floor plate	left front	1		22	+ N 902 867 03	hex. nut, self-locking with washer	M6	2	
(11)	820 863 360	cover floor plate	right front	1		23	N 907 287 02	innensechsrund-linsenschraube (kombi)	M5X16-E-Z1	1	
12	820 861 675	rotary latch		6		24	+ N 907 750 01	innensechsrund-blechschraube	4, 8X16	1	
13	820 864 449	clamping washer	18X5X1	6		25	+ N 908 214 01	expanding nut	D4, 8	1	
14	820 864 227	holder for cover		4		26		foot mat for models with additional floor covering ** see accessory catalogue **	front	X	
15	06/00-08/054PK	soul (black)		4		27		foot mat for models with additional floor covering ** see accessory catalogue **	rear	X	
	4B0 864 229	bracket for foot mat									
16	N 908 475 01	clips	12X9, 4	6							
17	822 864 775 B	bracket for foot support	rh	1		27A		bracket for foot mat ** see accessory catalogue **	rear	4	
18	821 864 777 B	base for foot support	lhd	1		27B		cover cap ** see accessory catalogue **		4	
	07/01-08/05E59	platinum	-YG,NH								
	06/00-08/051RS	twist (beige)	-YC,NV			28	820 857 379	shelf with cover		1	
	06/00-06/0124S	swing (dark grey)	-YB				07/01-08/05E59	platinum	-YG,NH		
	07/01-08/054PK	soul (black)	-YA,YH,YJ,YK, YL,QE,NE,NN, NP,NT,NU				06/00-08/051RS	twist (beige)	-YC,NV		
19	822 864 777 B	base for foot support rework if necessary	rh	1			06/00-06/0124S	swing (dark grey)	-YB		
(19)	08/00-06/0124S	swing (dark grey)	-YB				07/01-08/054PK	soul (black)	-YA,YH,YJ,YK, YL,QE,NE,NN, NP,NT,NU		
	822 864 777 C	base for foot support	rh	1							
	07/01-08/05E59	platinum	-YG,NH								
	08/00-08/051RS	twist (beige)	-YC,NV								