

## Toothed belt drive - exploded view

### 1 - Bolt

- Renew
- 12 Nm

### 2 - Cover (bottom) for toothed belt

### 3 - Bolt

- Tightening torque → Item

### 4 - Cover (rear) for toothed belt

### 5 - Bolt

- 10 Nm

### 6 - Bolt

- 50 Nm

### 7 - Idler roller

- For main drive toothed belt

### 8 - Screw plug

- 25 Nm

### 9 - O-ring

- Renew if damaged

### 10 - Cover (top) for toothed belt

### 11 - Bolt



**Caution**

**Bolt with left-hand thread!**

- Tightening torque → Item

### 12 - Main drive toothed belt

- Check for wear

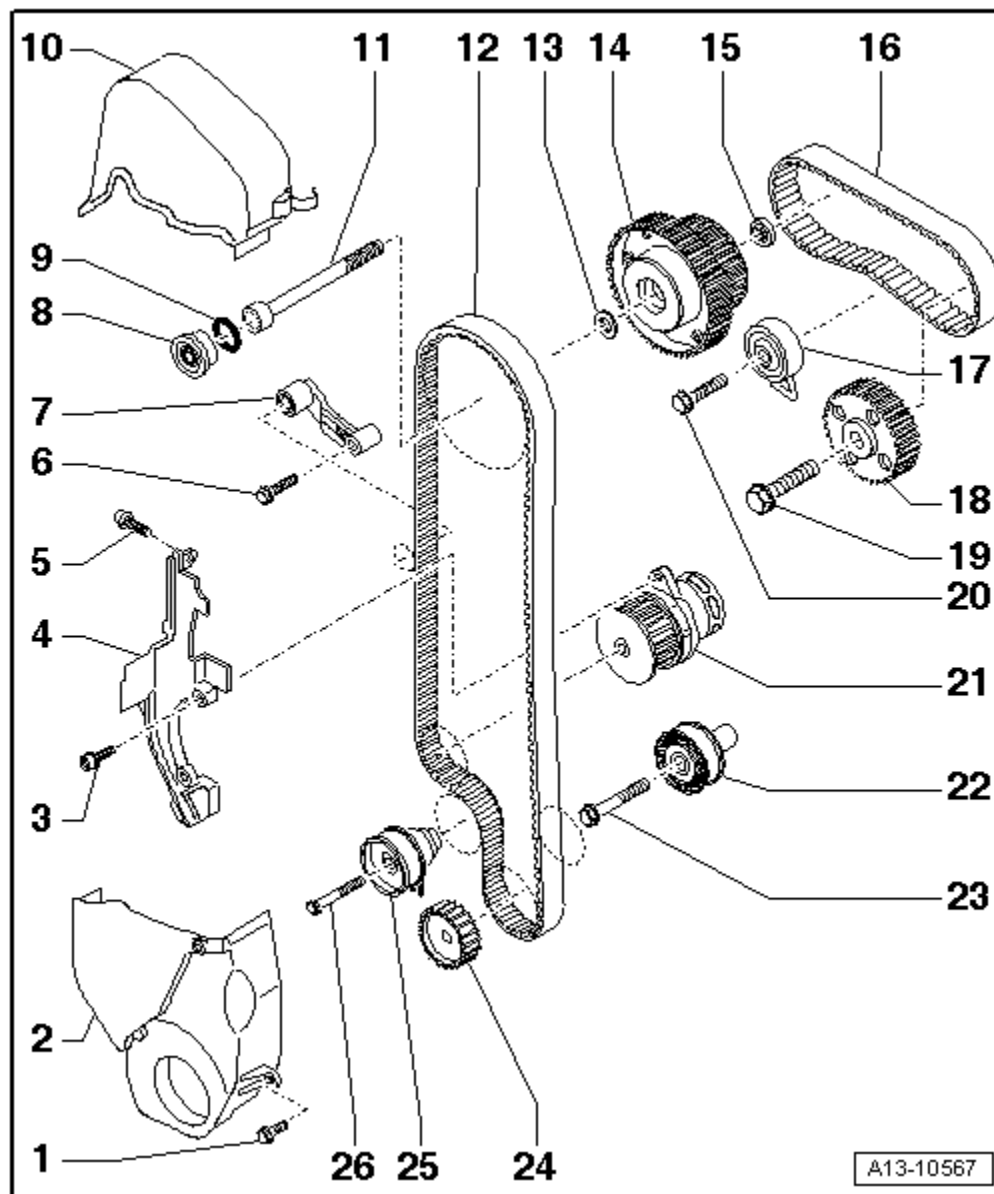

A13-10567

- ❑ Do not kink
- ❑ Before removing, mark direction of rotation with chalk or felt-tipped pen
- ❑ Removing and installing → [Chapter](#)

### **13 - Washer**

### **14 - Inlet camshaft sprocket with camshaft adjuster**

- ❑ Do not dismantle
- ❑ Removing and installing → [Chapter](#)

### **15 - Washer**

- ❑ Not fitted on later versions → [Electronic parts catalogue](#)
- ❑ If a washer was originally fitted, renew washer and install again

### **16 - Coupling drive toothed belt**

- ❑ Check for wear
- ❑ Do not kink
- ❑ Before removing, mark direction of rotation with chalk or felt-tipped pen
- ❑ Removing and installing → [Chapter](#)

### **17 - Tensioning roller**

- ❑ For coupling drive toothed belt
- ❑ Checking → [Chapter](#)

### **18 - Exhaust camshaft sprocket**

- ❑ Removing and installing → [Chapter](#)

### **19 - Bolt**

- ❑ Tightening torque → [Item](#)

### **20 - Bolt**

- ❑ 20 Nm

### **21 - Coolant pump**

- ❑ Removing and installing → [Chapter](#)

### **22 - Idler roller**

- ❑ For main drive toothed belt

### **23 - Bolt**

- ❑ 50 Nm

#### **24 - Crankshaft sprocket**

- ❑ Contact surface between sprocket and crankshaft must be free of oil
- ❑ Can only be installed in one position
- ❑ Detach after removing main drive toothed belt → Chapter

#### **25 - Tensioning roller**

- ❑ For main drive toothed belt
- ❑ Checking → Chapter

#### **26 - Bolt**

- ❑ 20 Nm