

Removing and installing rear door trim

1 - Door trim

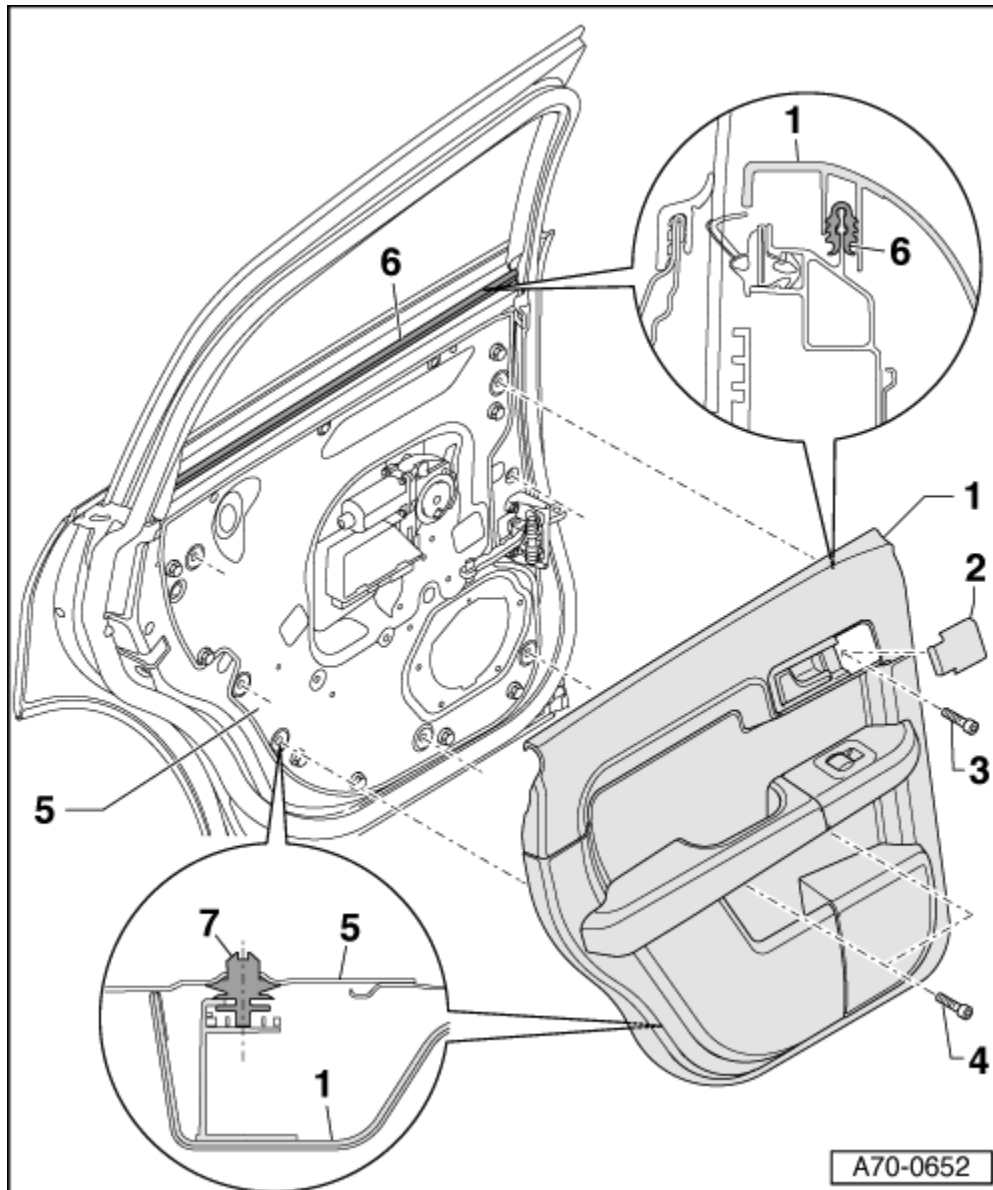

- ◆ Removing
- Vehicles with window crank: Remove window crank → [Chapter](#)
- Use flat screwdriver to prise out treble loudspeaker trim -2-.
- Unscrew bolt -3-.
- Screw bolts -4- (2x) out of door trim -1-.
- Unfasten door trim -1- at clips -7- (7x) from door shell.
- Lift door trim -1- out of retaining element -6-.
- Disengage Bowden cable for interior door handle → [Fig.](#)

- Unplug connector to treble loudspeaker → Fig.
- Unplug connector at window lifter control unit → Fig.

♦ Installing

- Replace damaged clips -7- → Fig.
- Attach wiring harnesses.
- Engage Bowden cable.
- Engage door trim -1- at retaining element -6-.
- Clip on door trim -1-.
- Screw on door trim -1-.

2 - Treble loudspeaker trim

3 - Bolt

- Tightening torque 2 Nm

4 - Bolts (2x)

- Tightening torque 2 Nm

5 - Door shell

6 - Retaining element

7 - Clips (7x)

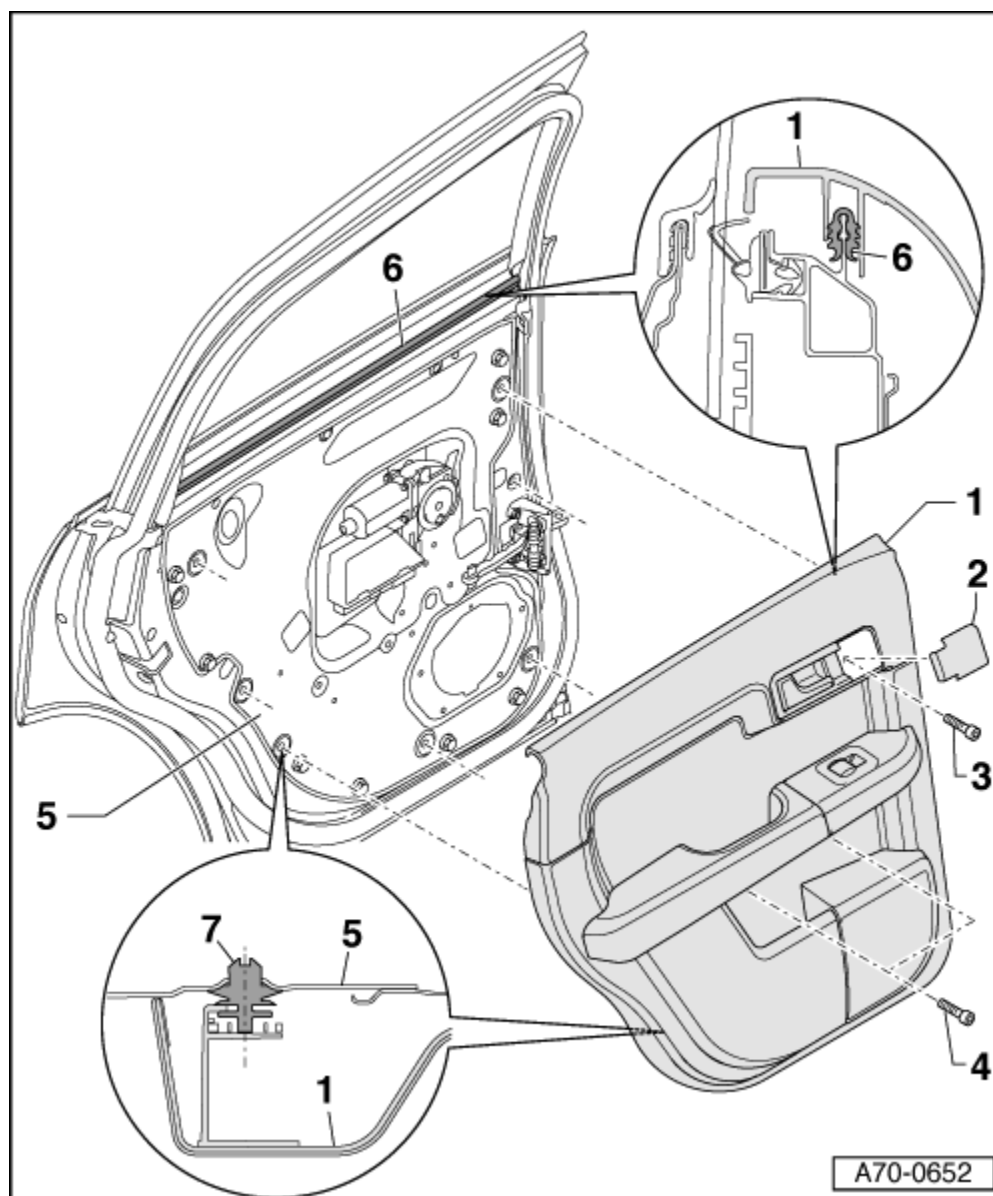

Disengaging Bowden cable

- Pull Bowden cable -1- out of guide -2- and disengage.



Note

On installation, make sure hook -3- is facing upwards.

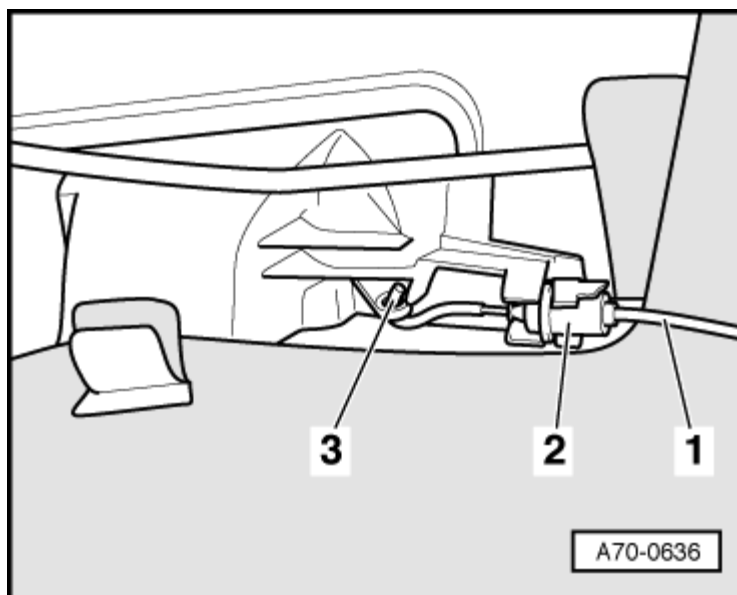

Treble loudspeaker connector

- Carefully press fasteners -2- in direction of arrow -B-.
- Unplug connector -3- in direction of arrow -A- from treble loudspeaker -1-.

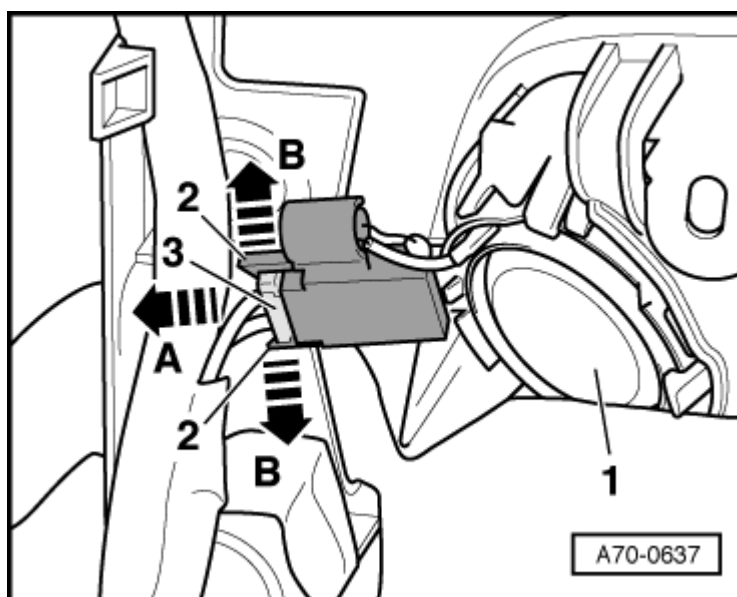

Connector at window lifter control unit

- Press retainer tab -2- and unplug connector -1- in direction of arrow.

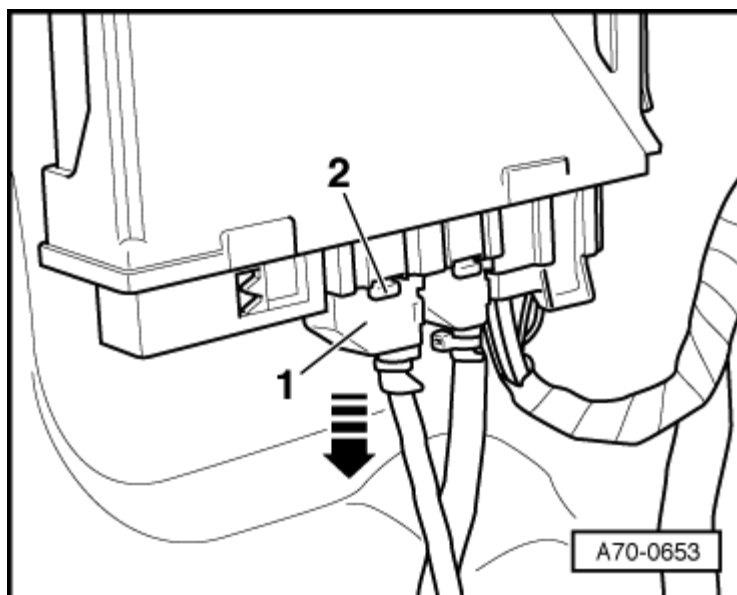

Door trim securing clip

- Press retainer tab -2- and pull out clip -1- in direction of arrow.

